

REVISIONS					
LTR	DESCRIPTION	DATE	REV.	CHKD.	APVD.

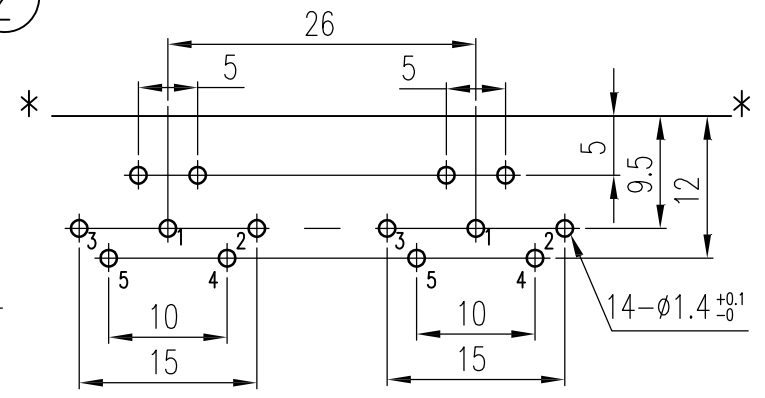

P.C.B Layout Dimension (Tolerance:±0.1)
(Recommend min.Dimension)(bottom view)

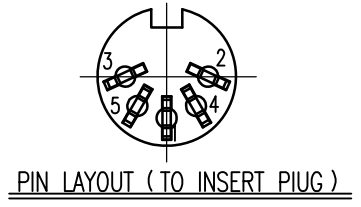
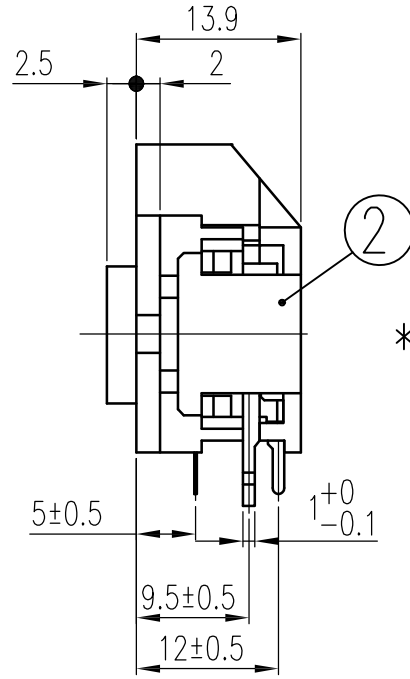
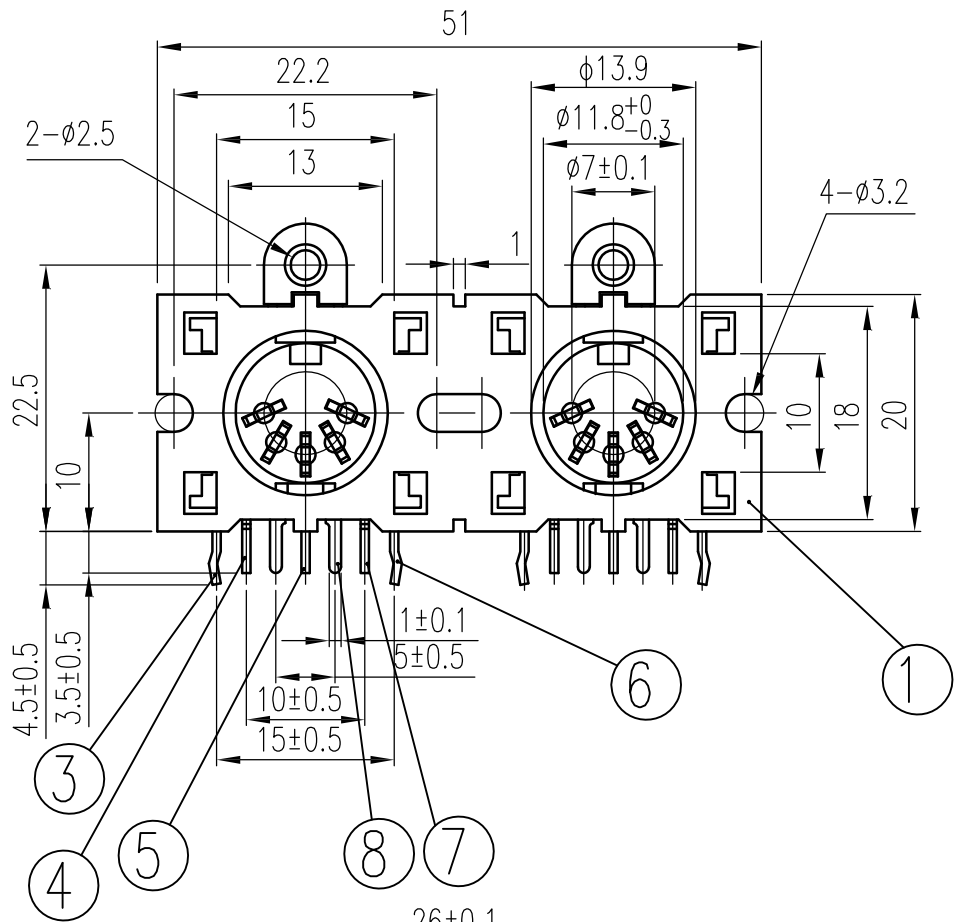
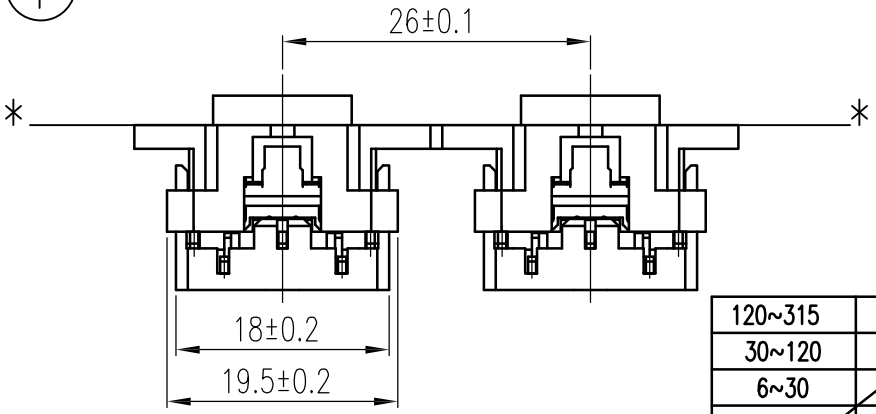

8	TIP SPRING	2	Copper Alloy t=0.2	MBCu-Sn
7	TERMINAL	2	Brass t=0.7	MBCu-Sn
6	TERMINAL	2	Brass t=0.7	MBCu-Sn
5	TERMINAL	2	Brass t=0.7	MBCu-Sn
4	TERMINAL	2	Brass t=0.7	MBCu-Sn
3	TERMINAL	2	Brass t=0.7	MBCu-Sn
2	COVER	2	PPO UL-94V-1	BLACK
1	HOUSING	1	PPO UL-94V-1	BLACK

LTR	PART NO.	QTY	MATERIAL	REMARK
120~315	±0.5	DWN	LORNA	DATE 2008.06.25
30~120	±0.35	DSND	LORNA	DATE 2008.06.25
6~30	±0.22	CHKD	Qilin/ALLAN	DATE 2008.06.26
BELOW 6	±0.16	APVD	Stanly	DATE 2008.06.26

DIMENSION	TOLERANCE	KUNMING ELECTRONICS CO.,LTD.			DWN.NO.	1/1
					A-052AP02	A

UNLESS OTHERWISE SPECIFIED, TOLERANCE ON DECIMAL: ±0.3 ANGLES: ±5°

SCALE N/A
PROJECTION
UNIT: mm
NAME DIN CONNECTOR
CAT. NO. HDC-052AP-02
DWN.NO. A-052AP02